

Working for You...
AND THE STATE OF HAWAII

Senator Donovan M. Dela Cruz

HAWAII STATE SENATE - DISTRICT 22
Mililani Mauka • Wahiawā • Whitmore Village • Waip'ō Acres • Wheeler • Poamoho



January 2017

Majority Whip

Vice Chair: Committee on Ways and Means; Committee on Transportation and Energy

Member: Committee on Education



You can view Senator Dela Cruz's senate website at www.capitol.hawaii.gov.



Subscribe to our E-Newsletter by emailing delacruz2@capitol.hawaii.gov.

Dane Wicker, Legislative Aide
(808) 586-7108
d.wicker@capitol.hawaii.gov

David Cho, Legislative Aide
(808) 586-6697
d.cho@capitol.hawaii.gov

Dot Fujinaga, Office Manager
(808) 586-6090
d.fujinaga@capitol.hawaii.gov

Hawaii State Senate
State Capitol
415 S. Beretania St., Rm. 202
Honolulu, HI 96813
P: 808-586-6090
F: 808-586-6091

Email:
sendelacruz@capitol.hawaii.gov

Aloha and Happy New Year!

The 29th Legislature is in session for the 2017 legislative session. As we have already begun to draft and introduce legislation, my focus and priorities are to build upon the following achievements we have completed over the years:

- Continuing to purchase agricultural land for food production
- Invest into education
- Create jobs in our community

With your support, the state has made significant progress in agriculture. Since the original purchase of 1,200 acres from the Galbraith Estate, the Agribusiness Development Corporation has acquired over 700 acres from Castle & Cooke and Dole Food Company; an additional 900 acres are pending purchase. ADC is working with the University of Arkansas Community Design Center to master plan the Whitmore Agribusiness Technology Park.

Also, I'll continue advocating for Mililani Middle School's need to transition to a single-track schedule. This past session, the Legislature appropriated \$11.5 million for a new classroom building. Governor Ige recently released \$1.725 million for plans and design, and the Dept. of Education has hired the University of Hawaii Community Design Center (UHCDC) for a proof of concept design. I will work with my colleagues to secure additional funds that are needed for construction.

Lastly, the High Technology Development Corporation expects to purchase by this spring the Mililani Technology Park Phase II for the First Responders Technology Campus and Cybersecurity Data Center. This campus would be the first joint facility that will house at least seven state and county first responders. Creating a multi-agency campus in Central Oahu will create jobs so residents can live, work, and play in the community.

If you would like more information on any of the above-mentioned projects, please don't hesitate to contact my office at 586-6090. I look forward to your continued support as we work to move Hawaii forward this legislative session!

Mahalo

Working for you!

District 22 Funding

I am pleased to announce that the Governor has released funding for the following capital improvement projects:

Wahiawa Middle School

- \$218,000 to reroof Building B



(Left) I met with the University of Hawaii Community Design Center and state and county first responders to discuss plans for the First Responders Technology Campus and Cybersecurity Data Center. (Below) The campus will consolidate facilities to enable the sharing of resources and support services. Preliminary plans for the First Responders Tech Campus & Cybersecurity Data Center were developed by the community design center.

AVENUE SCHEME

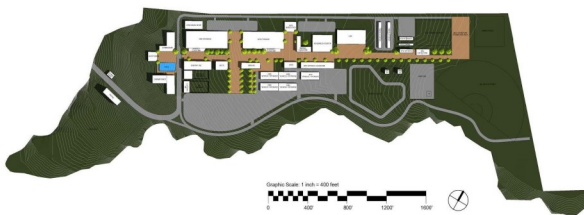

GREEN CAMPUS SCHEME

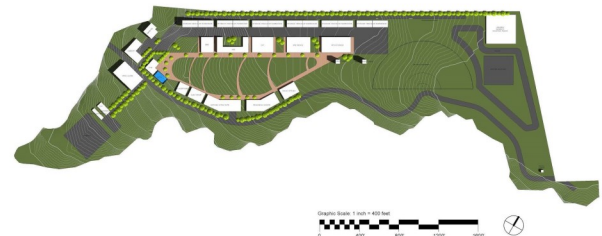

(Left) I invited U.S. Army Garrison-Hawaii Commander, Col. Stephen E. Dawson on a Whitmore Project site visit to learn about the state's effort to revitalize agriculture in Central Oahu. The military is an important partner in purchasing agricultural land. Recently, the US Navy, contributed \$1.81 million to the Agribusiness Development Corporation to purchase three parcels on Whitmore Avenue. Over 400 acres of ag land were preserved through this purchase.